

**Cliff Gardens, Telscombe Cliffs, Peacehaven, BN10 7BT**

**Asking Price £295,000**

**Council Tax Band: B**



This recently built bungalow offers a unique opportunity for those seeking a modern and stylish home. With its bespoke design, this single-storey residence boasts a spacious open-plan living area, enhanced by skylights that flood the space with natural light, creating a warm and inviting atmosphere. The property features a well-proportioned bedroom, perfect for relaxation, and a contemporary shower room that is both functional and aesthetically pleasing. The kitchen is exceptionally well-fitted with high-quality appliances, making it a delight for any culinary enthusiast.

Outside, the bungalow is complemented by secluded gardens, providing a tranquil retreat for outdoor enjoyment. The attention to detail and top-quality finish throughout the property ensures that it meets the highest standards of modern living.

This delightful home in Telscombe Cliffs is ideal for those looking for a peaceful yet convenient lifestyle, with local amenities and beautiful coastal walks just a stone's throw away. Whether you are a first-time buyer, a couple, or seeking a serene place to retire, this bungalow is a must-see.



206 South Coast Road, Peacehaven, East  
Sussex, BN10 8JP  
01273 830 987  
bnsales@localagent.co.uk

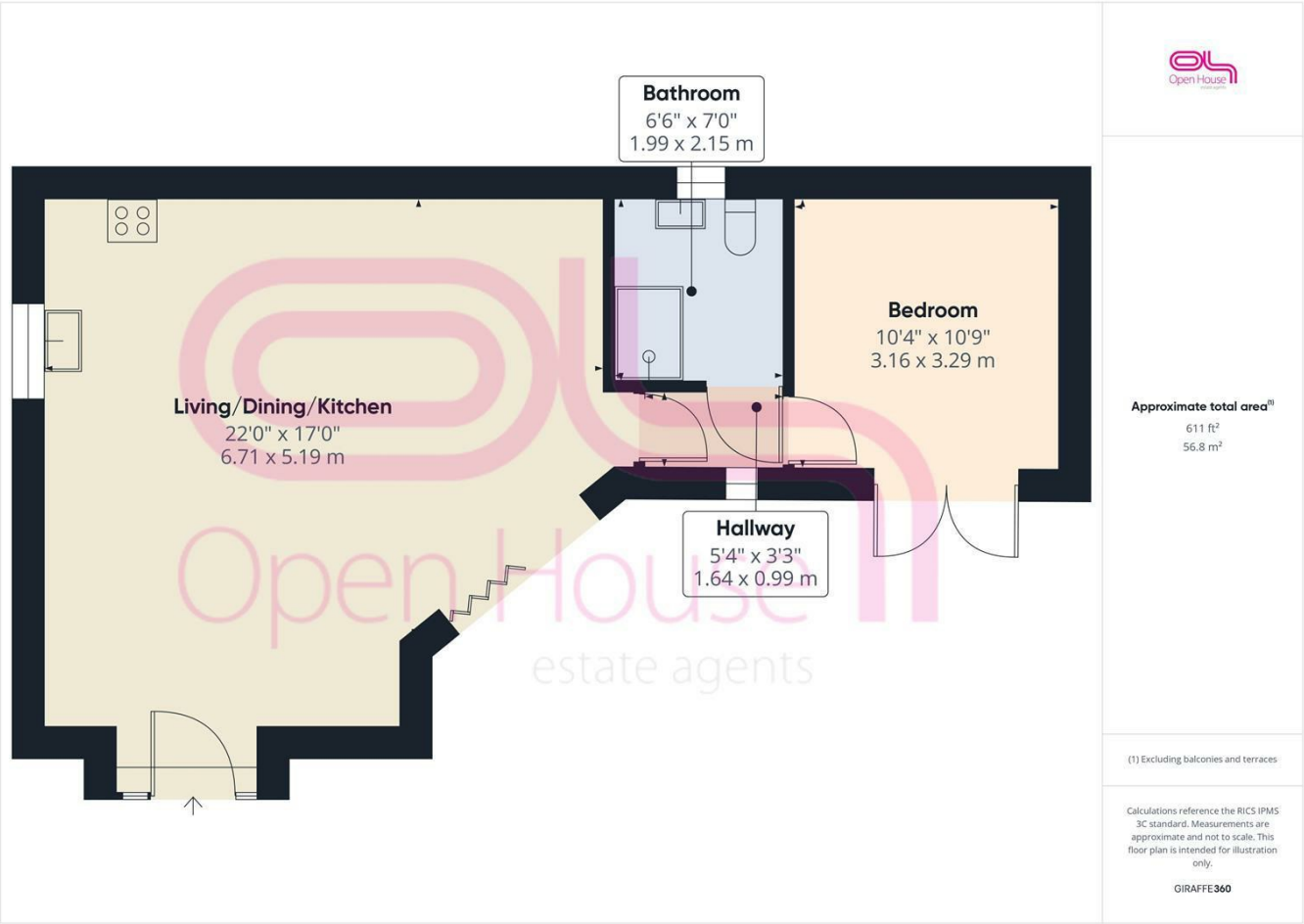

Energy Efficiency Rating		
	Current	Potential
Very energy efficient - lower running costs		
(92 plus) A		
(81-91) B		
(69-80) C	73	79
(55-68) D		
(39-54) E		
(21-38) F		
(1-20) G		
Not energy efficient - higher running costs		
England & Wales	EU Directive 2002/91/EC	